

Courses & Distances

S 37° E 64½
 S 50½° W 198
 N 32¾° E 211

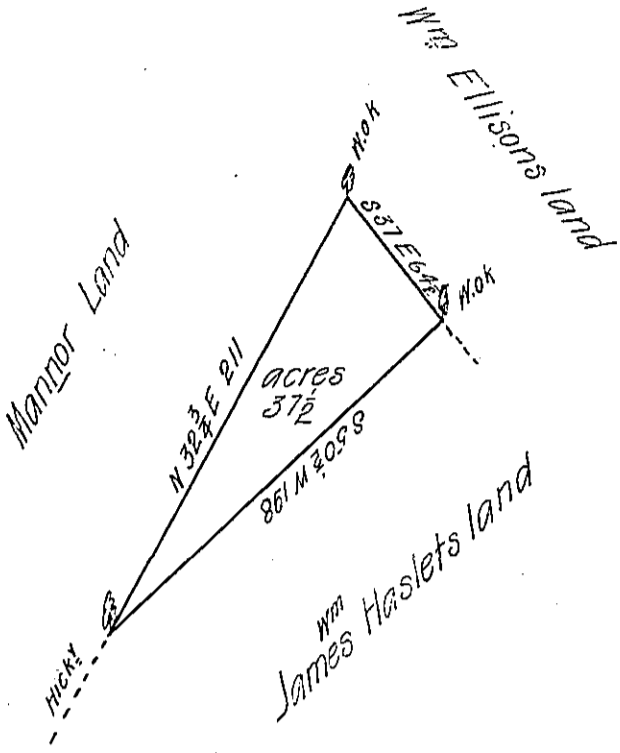

The Draught of a tract of land situate in Kishacoquillis valley in
 armagh township Cumberland County. Containing thirty seven acres & an half & the usual
 allowance of Six P^{ts} Cent for Roads &c^o. Surveyed for Margaret Miller Dec^r 28th
 1785 in pursuance of a Warrant from the Honorable the Vice President of the
 Supreme Executive Council, dated March the 11th 1785.

P. Sam^l Lyon D.S

To John Lukens Esq^r
 Surveyor General

IN TESTIMONY that the above is a copy of the original remaining on file in
 the Department of Internal Affairs of Pennsylvania, made
 conformably to an Act of Assembly approved the 16th day of
 February, 1833, I have hereunto set my Hand and caused
 the Seal of said Department to be affixed at Harrisburg,
 this.....seventh..... day of.....March..... 1906

Isaac S. Brown
 Secretary of Internal Affairs.